

ARE SHOWN ON F/D FOR REF ONLY.

000086

* AS NECESSARY TO REMOVE TRIM FABRIC.

	1	340-3397249-2	36	CARGO DOOR MESH FAIRING				
	1	340-3397249-1	35	CARGO DOOR MESH FAIRING				
	1	340 3397246-2005	34	PANEL INST (ABOVE DOOR)				
1	2	AN 364-10-32	33	NUT				
	2	AN 973-3	32	WASHER				
1	2	AN 386-1-11A	31	TAPER PIN				
	1	66B-41555-219	30	TRIM INST. (CARGO DOOR (LARGE VERSION))				
1	AS REQD	295910	28	RETAINING STRIP				
1	AS REQD	295248	27	RETAINING STRIP				
	1	66B-41514-39	26	TRIM FABRIC				
	1	66B-41514-37	25	TRIM FABRIC				
	1	340-3397247-22	24	BRACKET				
	1	340-3397247-21	23	BRACKET				

↑
ROOF LINING
FORE & AFT OF
CARGO DOOR
↓

66B-40012	STOCK DISPOSITION SYMBOLS								
	1 REWORK		2 SCRAP		3 NONE				
	REVISIONS	DISP.	REASON	EFF.	CLASS	APPD.			
						DES.	STR.	WTS.	
NC									

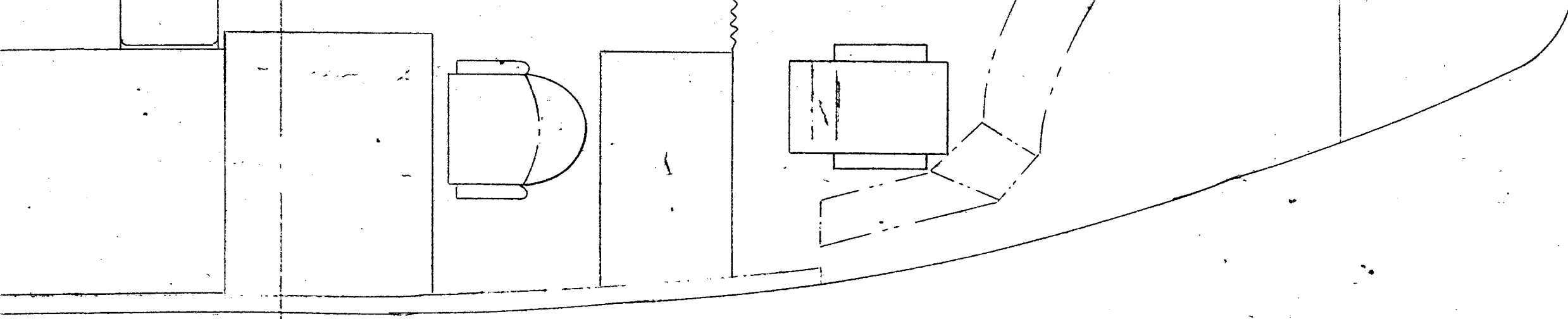

2. ALL PART NOS. WRITTEN IN FULL i.e. GGB-415XX-XX
ARE ITEMS TO BE REMOVED AND ARE SHOWN ON F/D FOR REF ONLY.

① RETAINED ITEMS.

NOTES:-



R.H.
NO. R
HEAT
FINISH
SIZE

CARGO DOOR
TRIM.

* AS NECESSARY TO REMOVE TRIM FABRIC.

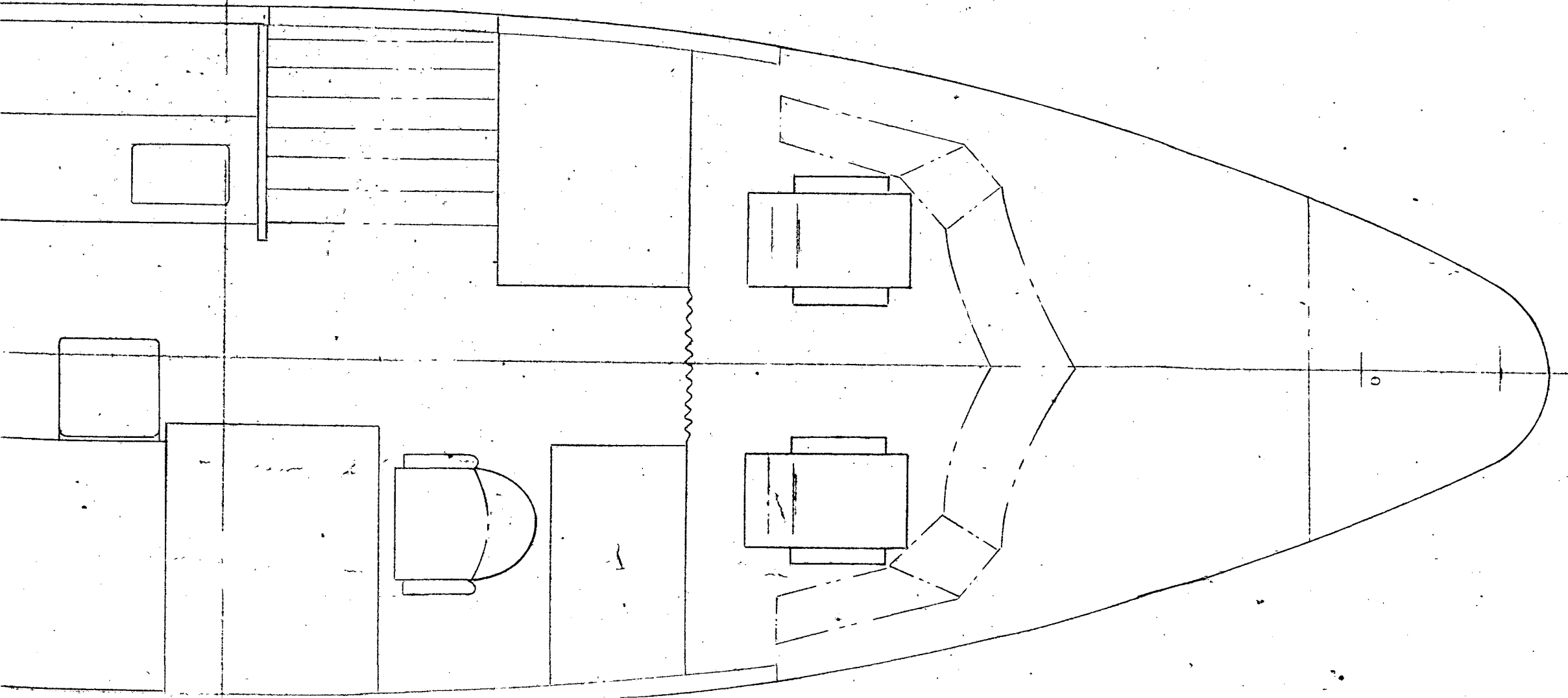
[illegible]

66D-41232	DISH	113	STORE
66B-41543-3	RETAINER CARPET	1	STORE
66B-41543-5	RETAINER CARPET	1	STORE
66B-41531-3	RETAINER CARPET	1	STORE
AN 507-832-R12	SCREW	14	STORE
AN 507-832-R10	SCREW	13	STORE
66B-41529-85	WAINSCOT	1	STORE
66B-41529-89	WAINSCOT	1	STORE
66B-41514-59	RETAINING STRIP	1	STORE
66B-41514-49	RETAINING STRIP	1	STORE
66B-41514-29	RETAINING STRIP	1	RETAIN
66B-41514-31	RETAINING STRIP	1	RETAIN
66B-41514-55	FELT	1	RETAIN
66B-41514-53	FELT	1	RETAIN
66B-41529-41	RETAINING STRIP	1	RETAIN
66B-41529-43	RETAINING STRIP	1	RETAIN
66B-41514-21	RETAINING STRIP	1	STORE
66B-41514-51	RETAINING STRIP	1	STORE
240-3393552	AIR INTAKE GRILL	2	RETAIN
99851-31	SPACER	20	RETAIN
NAS 387-8-16	SCREW	26	RETAIN
NAS 384-8-5	SCREW	4	RETAIN
NAS 384-8-14	SCREW	8	RETAIN
99851-37	SPACER	6	RETAIN
A814-82-3	NUT	11	RETAIN
Q92-1	CUP WASHER	4	RETAIN
66B-41514-25	TRIM FABRIC	1	STORE
66B-41514-23	TRIM FABRIC	1	STORE
295910	RETAINING STRIP	*	RETAIN
295248	RETAINING STRIP	*	RETAIN
66B-41555-3	TRIM INST CARGO DOOR	1	STORE
AN 386-1-11A	TAPER PIN	2	RETAIN
AN 973-3	WASHER	2	RETAIN

WAINSCOT
FORE & AFT.
OF CARGO
DOOR.

ROOF LINING
FORE & AFT
OF CARGO
DOOR

CARGO DOOR
TRIM.

* AS NECESSARY TO REMOVE TRIM FABRIC.

TO BE REMOVED

PART NO	DESCRIPTION	QTY	DISPOSITION
TE-605-2-44 LH	SEATS	10	STORE
TE-605-2-44 RH	SEATS	10	STORE
66B-41530-79	DURUG ASSY	1	STORE
↑ ↑ -81	↑ . ↑	1	STORE
↑ ↑ -83	↑ . ↑	1	STORE
↑ ↑ -85	↑ . ↑	1	STORE
↑ ↑ -87	↑ . ↑	1	STORE
66B-41530-89	DURUG ASSY	1	STORE
66B-41532	DISH	113	STORE
66B-41543-3	RETAINER CARPET	1	STORE
66B-41543-5	RETAINER CARPET	1	STORE
66B-41531-3	RETAINER CARPET	1	STORE
AN 507-832-R12	SCREW	14	STORE
AN 507-832-R10	SCREW	13	STORE
66B-41529-85	WAINSCOT	1	STORE
66B-41529-89	WAINSCOT	1	STORE
66B-41514-50	RETAINING STRIP	1	STORE
66B-41514-49	RETAINING STRIP	1	STORE
66B-41514-29	RETAINING STRIP	1	RETAIN
66B-41514-31	RETAINING STRIP	1	RETAIN
66B-41514-55	FELT	1	RETAIN
66B-41514-53	FELT	1	RETAIN
66B-41529-41	RETAINING STRIP	1	RETAIN
66B-41529-42	RETAINING STRIP	1	RETAIN

FLOOR
AREA.

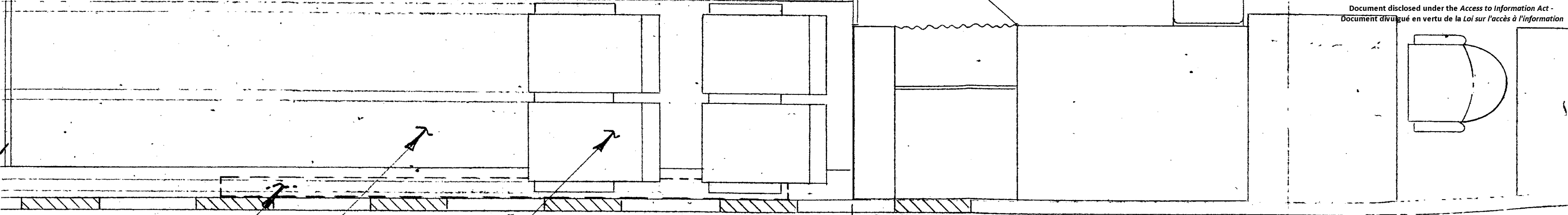

66B-41530-83

TE-605-2-44 RH

STA
283.5

66B-41543-3

66B-41543-5

AN507-8.32-R10 SCREW

SPACER 299851-37
 SCREW NAS 387-8-16
 66B-41514-29
 66B-41514-55

11 12 20 22

3552
 -5 SCREW
 -3 NUT
 CUP WASHER

529-41
 NAS 384-8-14 4REQ
 9814-82-3 4REQ

99851-31	Document disclosed under the Access to Information Act / Document divulgué en vertu de la Loi sur l'accès à l'information
A814-82-3	NUT
Q92-1	CUP WASHER
66B-41514-25	TRIM FABRI
66B-41514-23	TRIM FABRI
295910	RETAINING ST
295248	RETAINING ST
66B-41555-3	TRIM INST CARGO
AN 386-1-11A	TAPER PIN
AN 973-3	WASHER
AN 364-10-32	NUT
340-3397246-2001	PANEL INST (AP

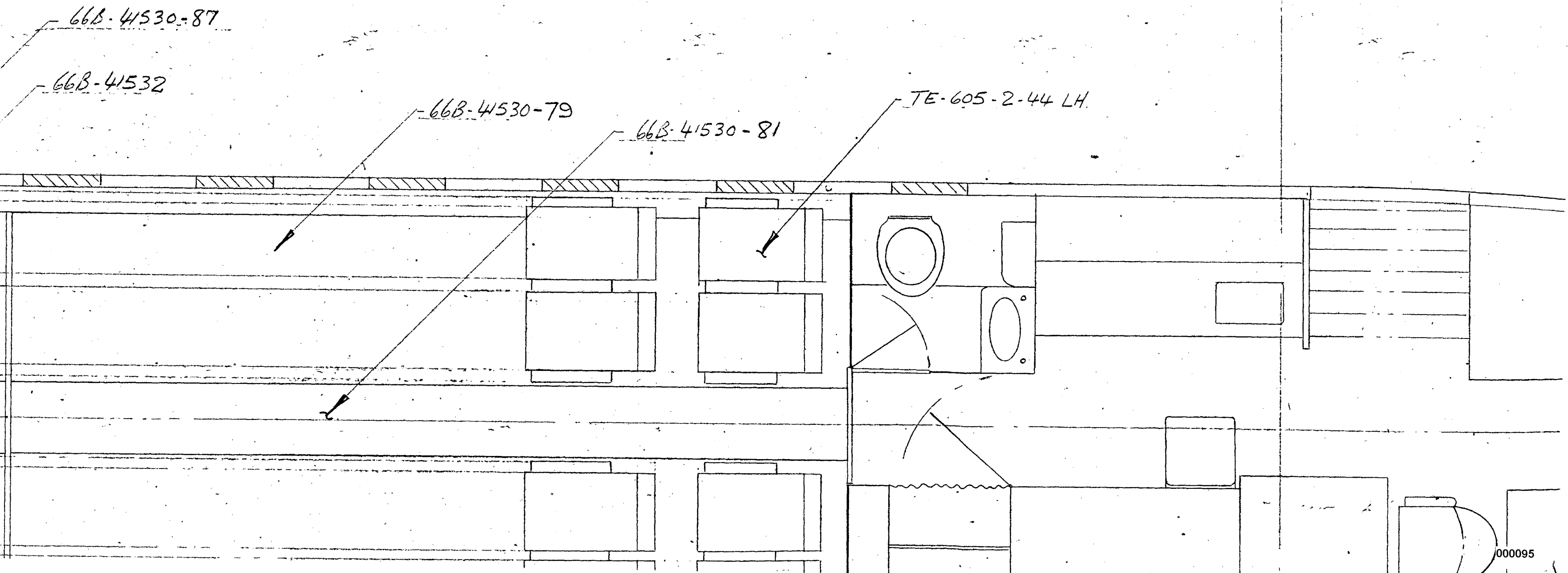

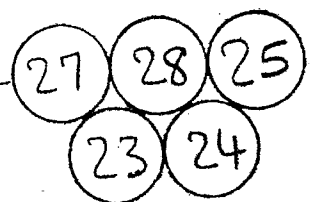

41529-85

NAS 384-8-5 SCREW 1REQ
A 814-82-3 NUT 1REQ (17)

66B-41514-50
SCREW NAS 387-8-16 7REQ
SPACER 299851-31 7REQ

SPACER 299851-37
SCREW NAS 387-8-16
66B-41514-29
66B-41514-55

3552
5 SCREW
-3 NUT

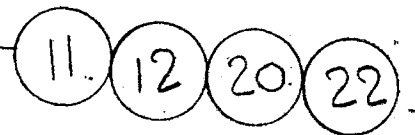

	85	Document disclosed under the Access to Information Act / Document divulgué en vertu de la Loi sur l'accès à l'information
	-87	
66B-41530	-89	DURUG ASSY
66B-41532		DISH
66B-41543	-3	RETAINER C
66B-41543	-5	RETAINER C
66B-41531	-3	RETAINER CA
AN 507-832	-R12	SCREW
AN 507-832	-R10	SCREW
66B-41529	-85	WAINSCOT
66B-41529	-89	WAINSCOT
66B-41514	-50	RETAINING STRIP
66B-41514	-49	RETAINING STRIP
66B-41514	-29	RETAINING STRIP
66B-41514	-31	RETAINING STRIP
66B-41514	-55	FELT
66B-41514	-53	FELT
66B-41529	-41	RETAINING STR
66B-41529	-43	RETAINING STR
66B-41514	-21	RETAINING ST
66B-41514	-51	RETAINING ST
240-3393552		AIR INTAKE GR
99851	-31	SPACER
NAS 387-8-16		SCREW
NAS 384-8-5		SCREW
NAS 384-8-14		SCREW
99851	-37	SPACER
A814-82-3		NUT
Q92-1		CUP WASHER
66B-41514	-25	TRIM FABR
66B-41514	-23	TRIM FABR
295910		RETAINING ST
295248		RETAINING ST
66B-41555	-3	TRIM INS 5000096 2G

27 28 25
23 24

41529--85

NAS 384-8-5 SCREW 1REQ
A 814-82-3 NUT 1REQ

17

TO BE REMOVED	
PART No	DESCRIPTION
TE-605-2-44 LH	SEATS
TE-605-2-44 RH	SEATS
66B-41530-79	DURUG ASSY
↑ -81	↑
↑ -83	↑
↑ -85	↑
↑ -87	↑
66B-41530-89	DURUG ASSY
66B-41532	DISH
66B-41543-3	RETAINER C
66B-41543-5	RETAINER C
66B-41531-3	RETAINER C
AN 507-832-R12	SCREW
AN 507-832-R10	SCREW
66B-41529-85	WAINSCOT
66B-41529-89	WAINSCOT
66B-41514-50	RETAINING STRIP
66B-41514-49	RETAINING STRIP
66B-41514-29	RETAINING STRIP
66B-41514-31	RETAINING STRIP
66B-41514-55	FELT
66B-41514-53	FELT
66B-41529-41	RETAININ ⁰⁰⁰⁰⁹⁷ TR
66B-41529-42	RETAINING STRIP

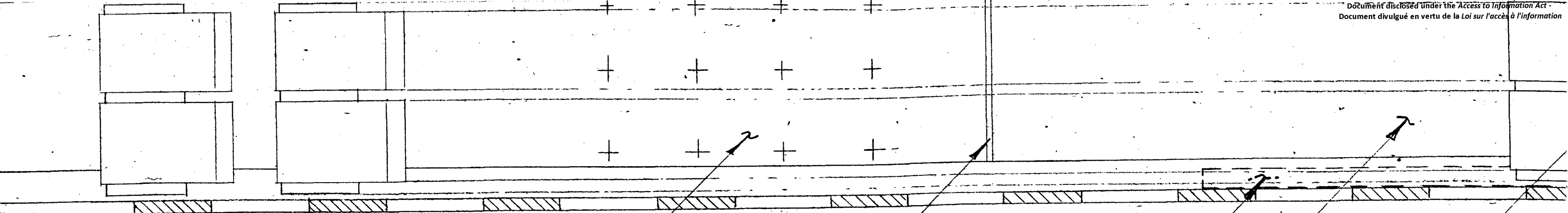

66B-41530-89

66B-41531-3
AN 507-832-R12 SCREW

66B-41530-83

TE-605-2-44

66B-41543-3
66B-41543-5
AN 507-832-R10 SCREW

A
4.5

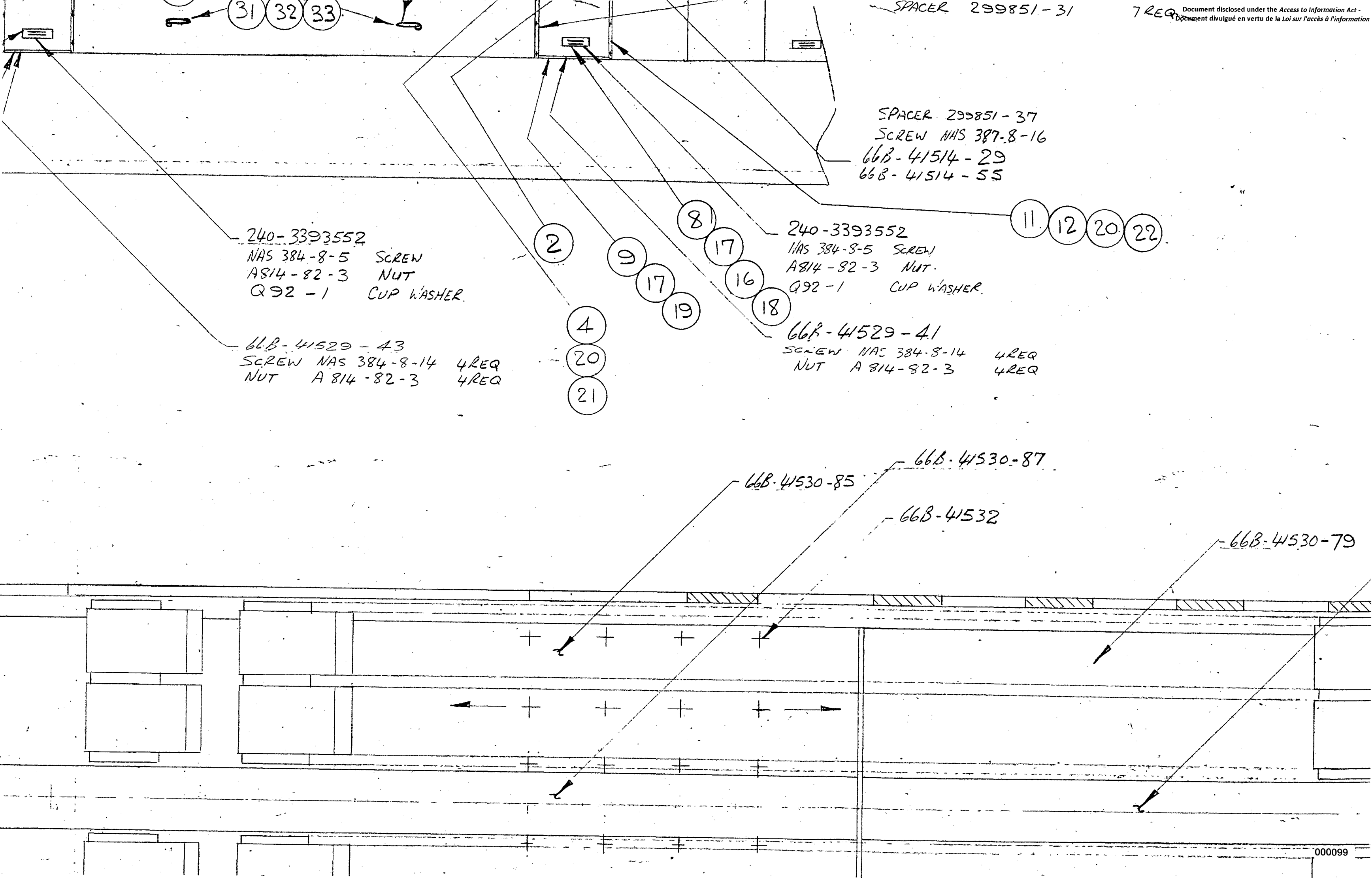

4 MECHANISM WILL BE FOUND STOWED IN TANDEM AT STA 820.95

INSTAL MECHANISM TO
340-3557500

INSTAL MECHANISM TO
340-3557500

(35) (36)

66B-41514-25

66B-41514-21

(27) (28) (25)
(23) (24)

66B-41529-89

66B-41514-23
295910 + 295248

66B-41529-85

3403397246-2001

(34)

66B-41524-43

(6)

NAS 384-8-5 SCREW 1REQ
A 814-82-3 NUT 1REQ

(17)

(3)
(20)
(21)

(30)

(31) (32) (33)

66B-41514-50
SCREW NAS 387-8-16 7REQ
SPACER 299851-31 7REQ

4 MECHANISM WILL BE FOUND STOWED IN TANDEM AT STA 820.95

INSTALL MECHANISM TO
340-3557500

INSTALL MECHANISM TO
340-3557500

(35) (36)

66B-41514-25

66B-41529-89

3403397246-2001

(34)

66B-41524-43

66B-41514-21

(27) (28) (25)
(23) (24)

66B-41514-23
295910 + 295248

(6)

66B-41529-85

NAS 384-8-5 SCREW 1REQ
A 814-82-3 NUT 1REQ

(17)

STA
820.95

STA
694.5

66

13 14
20 21

1

16 17 18 8

10
17
19

31 32 33

2

240-3393552
NAS 384-8-5 SCREW
A814-82-3 NUT
Q92-1 CUP WASHER

66B-41529-43
SCREW NAS 384-8-14 4REQ
NUT A 814-82-3 4REQ

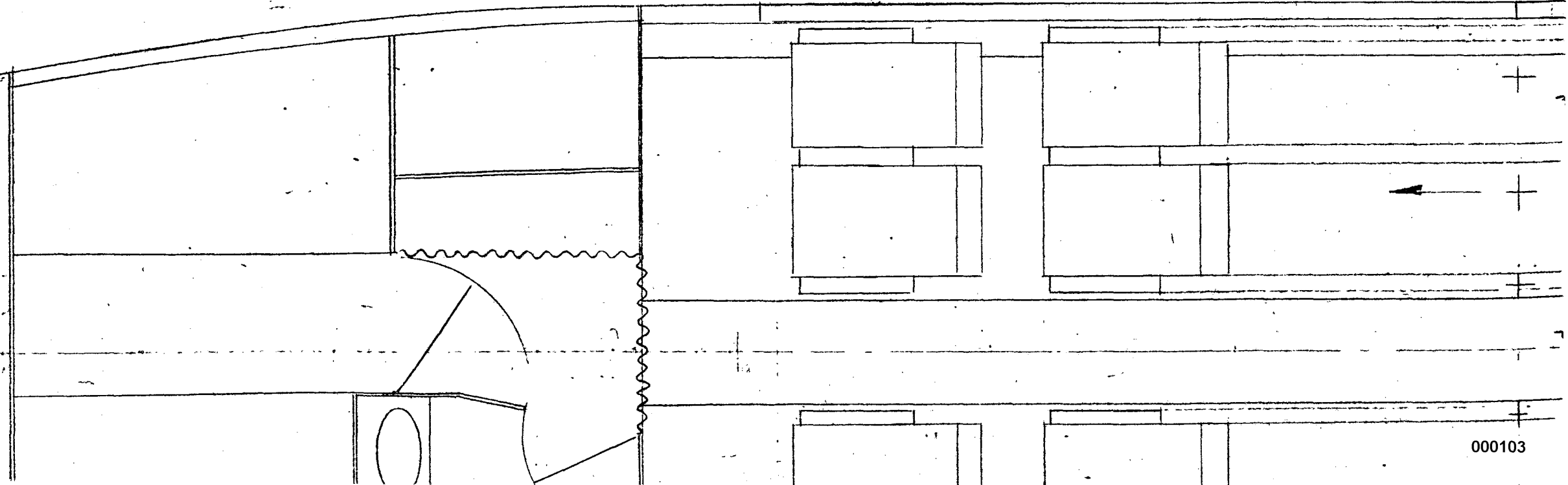
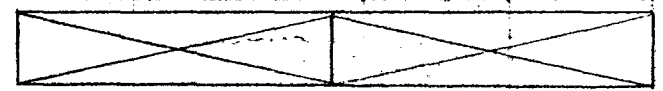

HANDLES & MECHANISM WILL BE FOUND STOWED IN TANDEM AT STA

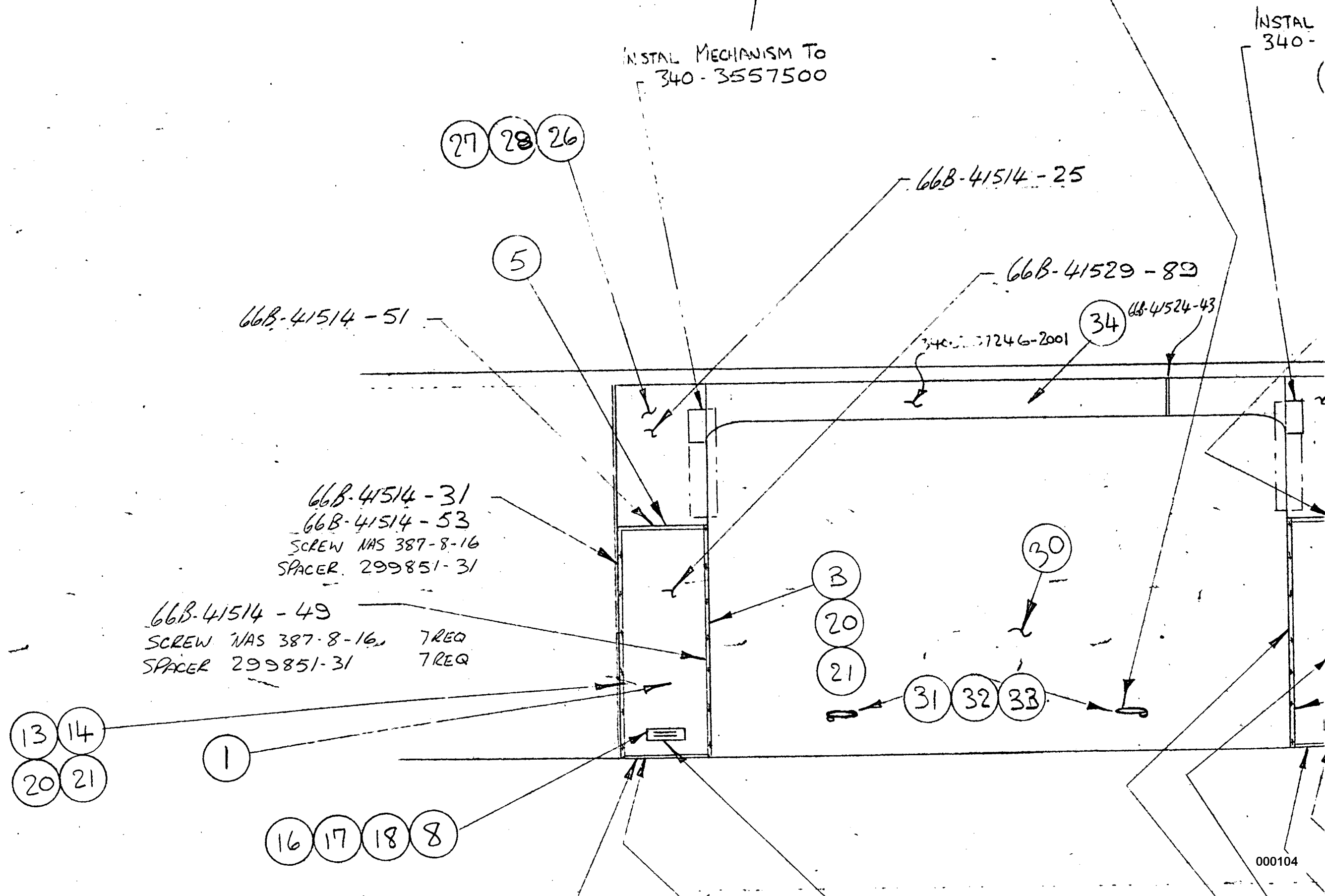

HANDLES & MECHANISM WILL BE FOUND STOWED IN TANDEM AT STA

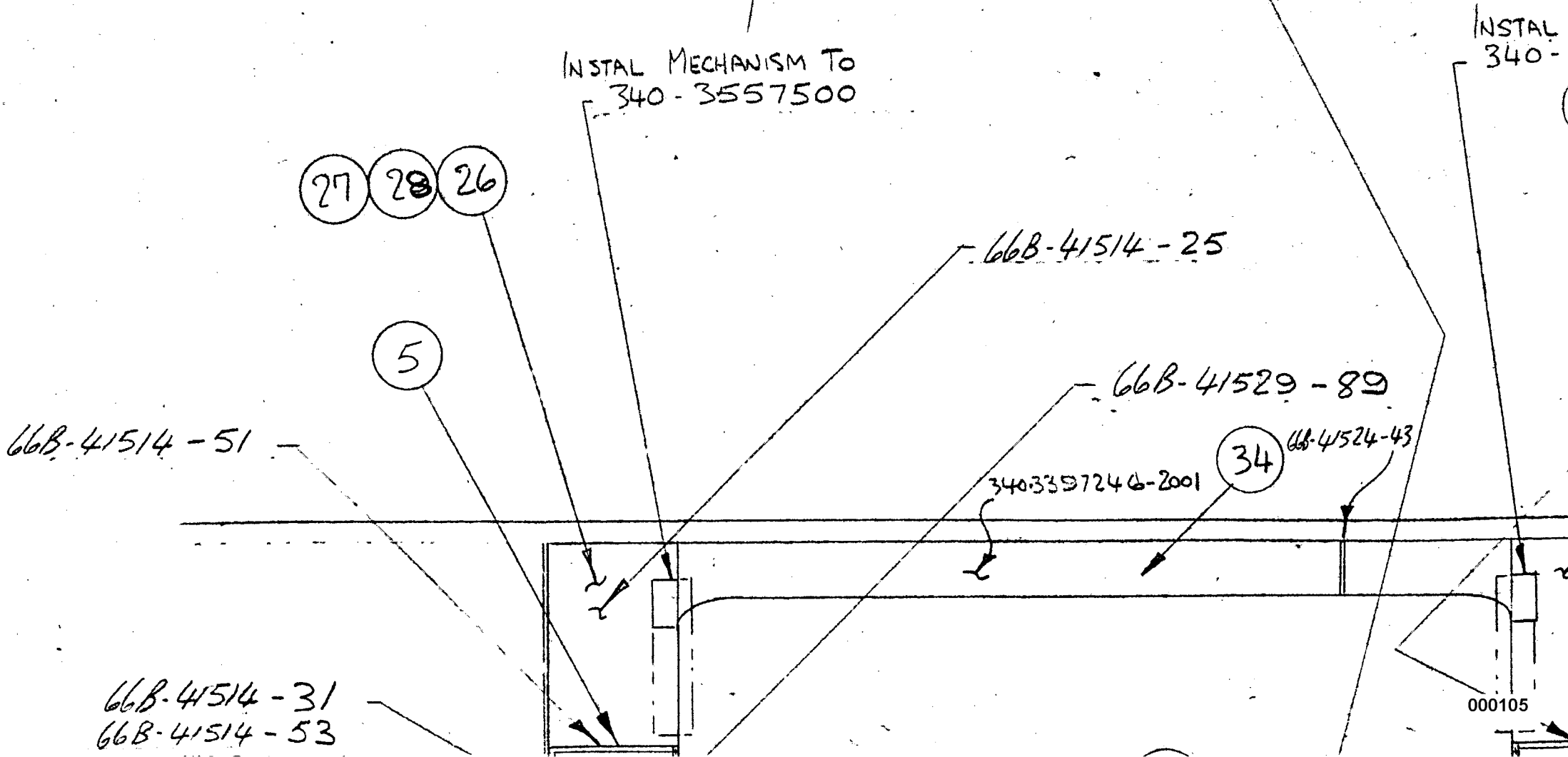

SFA
820-95

13 14
20 21

1

16 17 18 8

10
17
19

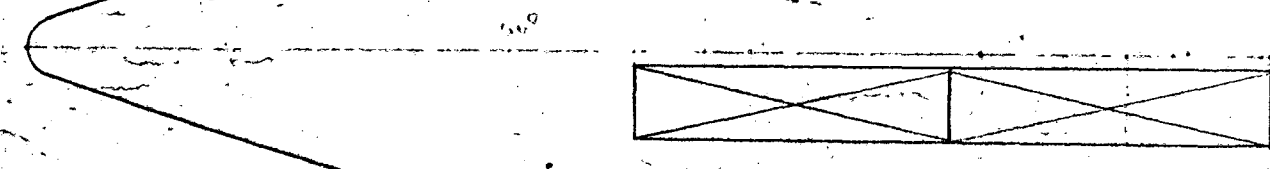

HAND

27 28 26

5

66B-41514-51

66B-41514-31
66B-41514-53
SCREW NAS 387-8-16
SPACER 299851-31

66B-41514-49
SCREW NAS 387-8-16 7REQ
SPACER 299851-31 7REQ

13 14

1

HAND

27 28 26

5

66B-41514-51

66B-41514-31
66B-41514-53